



Brass & bronze valves

Brass & bronze valves

CLASS 125

BRONZE GATE VALVE

Screwed Bonnet, Rising Stem
Threaded ends to BS21 (JIS B0203)

1.2MPa WOG non-shock, Saturated steam pressure 0.8MPa

⚠ Don't use for Flammable gas or Toxic gas



fig.M



Dimensions

Nominal Size	unit:mm									
	inch	1/4	3/8	1/2	3/4	1	1 1/4	1 1/2	2	
	mm	8	10	15	20	25	32	40	50	
L		42	42	50	51	60	68	72	83	
H		123	123	124	149	181	205	241	294	
D		54	54	54	61	77	77	83	105	

Materials

Parts	Material (JIS)
Body	CAC406
Bonnet	CAC406
Disc	CAC406
Stem	C4622
Gland packing	PTFE

CLASS 125

BRONZE GATE VALVE

Screwed Bonnet, Non-Rising Stem
Threaded ends to BS21 (JIS B0203)

1.2MPa WOG non-shock, Saturated steam pressure 0.8MPa

⚠ Don't use for Flammable gas or Toxic gas



fig.E



Dimensions

Nominal Size	unit:mm									
	inch	1/4	3/8	1/2	3/4	1	1 1/4	1 1/2	2	
	mm	8	10	15	20	25	32	40	50	
L		42	42	50	51	60	85	72	83	
H		75	75	77	91	107	123	139	170	
D		54	54	54	61	77	77	83	105	

Materials

Parts	Material (JIS)
Body	CAC406
Bonnet	CAC406
Disc	CAC4061
Stem	CA622
Gland packing	PTFE

Brass & bronze valves

CLASS 125

BRASS GATE VALVE

Screwed Bonnet, Non-rising Stem
Threaded ends to BS21 (JIS B0203)

1.2MPa WOG non-shock

⚠ Don't use for Flammable gas or Toxic gas



Fig.FR



Dimensions

Nominal Size	inch	1/2	3/4	1	1 1/4	1 1/2	2
	mm	15	20	25	32	40	50
L		43	47	54	61	65	72
H		72	84	98	116	125	153
D		54	54	61	77	77	83

unit:mm

Materials

Parts	Material (JIS)
Body	CAC203
Bonnet	CAC203
Stem	C3604BD
Disc	CA203
Gland packing	PTFE

CLASS 125

BRASS GATE VALVE

Screwed Bonnet, Non-rising Stem
Threaded ends to BS21 (JIS B0203)

1.2MPa WOG non-shock

⚠ Don't use for Flammable gas or Toxic gas



Fig.FG



Dimensions

Nominal Size	inch	3/8	1/2	3/4	1	1 1/4	1 1/2	2	2 1/2	3	4
	mm	10	15	20	25	32	40	50	65	80	100
L		38	42	46	50	59	62	72	89	100	116
H		75	77	89	103	120	131	157	186	222	258
D		54	54	54	61	77	77	83	105	132	132

unit:mm

Materials

Parts	Material (JIS)
Body	C3771BE (10A~40A) CAC203 (50A~100A)
Bonnet	C3771BE (10A~50A) CAC203 (65A~100A)
Stem	C3604BD
Disc	C3771B
Gland packing	PTFE

CLASS 150

BRONZE GATE VALVE

Screwed Bonnet, Non-rising Stem
Threaded ends to BS21 (JIS B0203)

2MPa WOG non-shock, Saturated steam pressure 1MPa

⚠ Don't use for Flammable gas or Toxic gas



Fig.FE



Dimensions

Nominal Size	inch	1/2	3/4	1	1 1/4	1 1/2	2
	mm	15	20	25	32	40	50
L			53				
H			110				
D			61				

unit:mm

Materials

Parts	Material (JIS)
Body	CAC406
Bonnet	CAC406
Stem	C3771BD
Disc	CAC406
Gland packing	Moulded Graphite

Brass & bronze valves

CLASS 100

BRASS GLOBE VALVE

Screwed Bonnet, Rising Stem
Threaded ends to BS21 (JIS B0203)

1MPa WOG non-shock

⚠ Don't use for Flammable gas or Toxic gas



Fig.TA

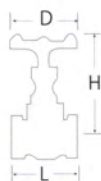

Dimensions

Nominal Size	inch	1/2	3/4	1	1 1/4	1 1/2	2
	mm	15	20	25	32	40	50
L		48	53	63	73	81	94
H		66	71	84	101	106	130
D		54	54	61	68	77	83

unit:mm

Materials

Parts	Material (JIS)
Body	CAC203
Bonnet	C3771BD
Stem	C3604BD
Disc	C3604BD
Gland packing	PTFE

CLASS 150

BRASS/BRONZE GLOBE VALVE

Screwed Bonnet, Rising Stem
Threaded ends to BS21 (JIS B0203)

1.4MPa WOG non-shock

⚠ Don't use for Flammable gas or Toxic gas



Fig.TC



Dimensions

Nominal Size	inch	1/4	3/8	1/2	3/4	1	1 1/4	1 1/2	2
	mm	8	10	15	20	25	32	40	50
L		44	44	53	65	77	85	100	119
H		66	66	71	84	98	123	143	174
D		54	54	54	61	77	77	83	105

unit:mm

Materials

Parts	Material (JIS)
Body	CAC203 (8A~25A) CAC406 (32A~50A)
Bonnet	C3771BD/CAC406
Stem	C3604BD
Disc	C3604BD/CAC406
Gland packing	PTFE

CLASS 150

BRONZE ANGLE VALVE

Screwed Bonnet, Angle type body, Rising Stem
Threaded ends to BS21 (JIS B0203)

1.4MPa WOG non-shock

Saturated steam pressure 1MPa

⚠ Don't use for Flammable gas or Toxic gas



Fig.CL



Dimensions

Nominal Size	inch	1/2
	mm	15
L		26.5
H		78
D		54
L1		28

unit:mm

Materials

Parts	Material (JIS)
Body	CAC406
Bonnet	C3771BD
Stem	C3604BD
Disc	C3604BD
Gland packing	PTFE

Brass & bronze valves

CLASS 125

BRASS/BRONZE SWING CHECK VALVE

Screwed Cap, Swing type disc
Threaded ends to BS21 (JIS B0203)

1.2MPa WOG non-shock

⚠ Don't use for Flammable gas or Toxic gas



Fig.TS

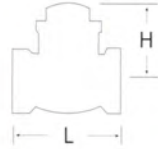

Dimensions

Nominal Size	inch mm	unit:mm									
		3/8	1/2	3/4	1	1 1/4	1 1/2	2	2 1/2	3	
L		52	52	59	69	79	89	109	140	165	
H		38	38	40	45	51	55	67	84	100	

Materials

Parts	Material (JIS)
Body	CAC203 (10A~50A) CAC406 (65A,80A)
Cap	CAC203 (10A~50A) CAC406 (65A,80A)
Hing pin	C3604BD
Disc	C3771BE (10A~50A) CAC406 (65A,80A)

CLASS 150

BRASS/BRONZE Y-PATTERN STRAINER

Y-Pattern Body, Screwed cap, 304 stainless steel screen
Threaded ends to BS21 (JIS B0203)

1.4MPa WOG non-shock

⚠ Don't use for Flammable gas or Toxic gas



Fig.Y

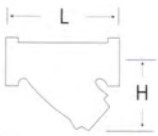

Dimensions

Nominal Size	inch mm	unit:mm									
		3/8	1/2	3/4	1	1 1/4	1 1/2	2	2 1/2	3	
L		70	80	100	115	135	160	195	230	240	
H		43	49	58	71	82	98	120	150	180	

Materials

Parts	Material (JIS)
Body	CAC203 (10A~50A) CAC406 (65A,80A)
Cap	C3771BE (10A~50A) CAC406 (65A,80A)
Screen	Type 304 Stainless steel

CLASS 10K

BRASS METRE COCK

Threaded ends to BS21 (JIS B0203)

1.0MPa WOG non-shock

⚠ Don't use for Flammable gas or Toxic gas



Fig.BM

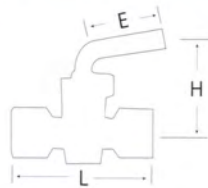

Dimensions

Nominal Size	inch mm	unit:mm		
		1/4	3/8	1/2
L		55	60	70
H		40	40	46
E		35	35	41

Materials

Parts	Material (JIS)
Body	C3771BE
Teper plug	C3771BE
Packing	NBR
Packing nut	C3604BD

Ball valves

TYPE 400

BRASS BALL VALVE, STANDARD BORE

Screwed Body cap, Blowout-proof Stem
Threaded ends to BS21 (JIS B0203)

2.8MPa WOG non-shock and 0.7 MPa WOG non-shock at 150°C

⚠ Don't use for Flammable gas or Toxic gas



Fig.BA

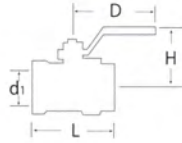

Dimensions

Nominal Size	unit:mm											
	inch	1/4	3/8	1/2	3/4	1	1 1/4	1 1/2	2	2 1/2	3	4
	mm	8	10	15	20	25	32	40	50	65	80	100
d1		9	9	10	15	19	25	32	38	50	63	75
L		39	39	49	53	63	72	83	92	117	137	157
H		32	32	37	40	47	52	60	65	79	89	98
D		50	50	75	75	100	100	125	125	200	200	200

Materials

Parts	Material (JIS)
Body/cap	C3771BE
Ball	C3604/C3771BD Nickel-chrome plated
Stem	C3604BD
Packing	PTFE
Ball seat	PTFE

TYPE 400

BRASS BALL VALVE, STANDARD BORE

Screwed Body cap, Blowout-proof Stem, with Wing-handle
Threaded ends to BS21 (JIS B0203)

2.8MPa WOG non-shock and 0.7 MPa WOG non-shock at 150°C

⚠ Don't use for Flammable gas or Toxic gas



Fig.BAT

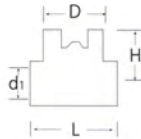

Dimensions

Nominal Size	unit:mm						
	inch	1/4	3/8	1/2	3/4	1	1 1/4
	mm	8	10	15	20	25	32
d1		9	9	10	15	19	25
L		39	39	49	53	63	72
H		37	37	38	40	47	52
D		69	69	69	69	83	83

Materials

Parts	Material (JIS)
Body/cap	C3771BE
Ball	C3604/C3771BD Nickel-chrome plated
Stem	C3604BD
Packing	PTFE
Ball seat	PTFE

Ball valves

TYPE 600

BRASS BALL VALVE, FULL BORE

Screwed Body cap, Blowout-proof Stem
Double O-ring stem seals
Threaded ends to BS21 (JIS B0203)

4.1MPa WOG non-shock and 1.0 MPa WOG non-shock at 150°C

⚠ Don't use for Flammable gas or Toxic gas



Fig.BZ

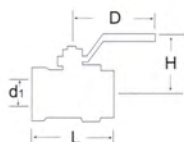

Dimensions

Nominal Size	inch mm	unit:mm							
		1/4	3/8	1/2	3/4	1	1 1/4	1 1/2	2
d1		10	10	15	20	25	32	40	50
L		50	50	65	68	79	86	96	109
H		37	37	40	44	50	55	65	72
D		70	70	80	80	110	110	150	150

Materials

Parts	Material (JIS)
Body/cap	C3771BE
Ball	C3604BE Nickel-chrome plated
Stem	C3604BD Nickel plated
O-ring	FKM
Ball seat	PTFE

TYPE 600

BRASS BALL VALVE, FULL BORE

Screwed Body cap, Blowout-proof Stem
Double O-ring stem seals
Threaded ends to BS21 (JIS B0203)

4.1MPa WOG non-shock and 1.0 MPa WOG non-shock at 150°C

⚠ Don't use for Flammable gas or Toxic gas



Fig.BZT

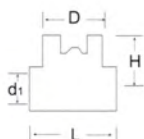

Dimensions

Nominal Size	inch mm	unit:mm					
		1/4	3/8	1/2	3/4	1	1 1/4
d1		10	10	15	20	25	32
L		50	50	65	68	79	86
H		35	35	41	45	54	61
D		55	55	70	70	100	100

Materials

Parts	Material (JIS)
Body/cap	C3771BE
Ball	C3604BE Nickel-chrome plated
Stem	C3604BD Nickel plated
O-ring	FKM
Ball seat	PTFE

TYPE 400

BRASS BALL VALVE, FULL BORE

Screwed Body cap, Blowout-proof Stem
Double O-ring stem seals
Threaded ends to BS21 (JIS B0203)

2.8MPa WOG non-shock and 0.7 MPa WOG non-shock at 150°C

⚠ Don't use for Flammable gas or Toxic gas



Fig.BO

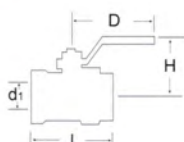

Dimensions

Nominal Size	inch mm	unit:mm							
		1/2	3/4	1	1 1/4	1 1/2	2	2 1/2	3
d1		12.7	19	25	32	38	50	63	75
L		47	57	67	81	89	107	130	149
H		34	42	45	55	59	72	83	103
D		75	108	108	122	122	185	185	250

Materials

Parts	Material (JIS)
Body/cap	C3771BE
Ball	C3604/C3771BD Nickel-chrome plated
Stem	C3604BD
O-ring	FKM
Ball seat	PTFE

Ball valves

TYPE 400

BRASS BALL VALVE, STANDARD BORE

Screwed Body cap, Blowout-proof Stem
Double O-ring stem seals
Threaded ends to BS21 (JIS B0203)

2.8MPa WOG non-shock and 0.7 MPa WOG non-shock at 150°C

⚠ Don't use for Flammable gas or Toxic gas



Fig.B

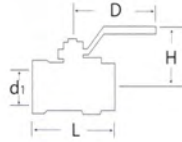

Dimensions

Nominal Size	unit:mm								
	inch	1/4	3/8	1/2	3/4	1	1 1/4	1 1/2	2
	mm	8	10	15	20	25	32	40	50
d1		10	10	10	15	19	25	32	40
L		50	50	65	68	79	86	96	109
H		45	45	45	48	55	59	65	75
D		80	80	100	100	130	130	130	100

Materials

Parts	Material (JIS)
Body/cap	C3771BE
Ball	C3604/C3771BD Nickel-chrome plated
Stem	C3604BD
O-ring	FKM
Ball seat	PTFE

TYPE 400

BRASS BALL VALVE, STANDARD BORE

Screwed Body cap, Blowout-proof Stem, with Wing-handle
Double O-ring stem seals
Threaded ends to BS21 (JIS B0203)

2.8MPa WOG non-shock and 0.7 MPa WOG non-shock at 150°C

⚠ Don't use for Flammable gas or Toxic gas



Fig.BT

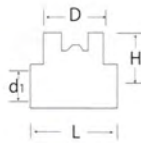

Dimensions

Nominal Size	unit:mm						
	inch	1/4	3/8	1/2	3/4	1	1 1/4
	mm	8	10	15	20	25	32
d1		10	10	10	15	19	25
L		50	50	65	68	79	86
H		46	46	46	49	56	60
D		65	65	65	65	90	90

Materials

Parts	Material (JIS)
Body/cap	C3771BE
Ball	C3604/C3771BD Nickel-chrome plated
Stem	C3604BD
O-ring	FKM
Ball seat	PTFE

Ball valves

TYPE 600

BRASS BALL VALVE, REDUCED BORE

One-piece Body, Blowout-proof Stem
Threaded ends to BS21 (JIS B0203)

4.1MPa WOG non-shock and 1 MPa WOG non-shock at 150°C

⚠ Don't use for Flammable gas or Toxic gas



Fig.BK

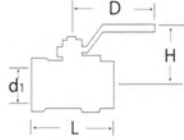

Dimensions

Nominal Size	unit:mm					
	inch	1/4	3/8	1/2	3/4	1
	mm	8	10	15	20	25
d1		5	7.5	9	12.5	16
L		40	44.5	54.5	61	75
H		31	40	42	51	55
D		60	80	80	100	100

Materials

Parts	Material (JIS)
Body/cap	C3771BE
Ball	C3604/C3771BD Nickel-chrome plated
Stem	C3604BD
Packing	R-PTFE
Ball seat	R-PTFE

TYPE 600

BRASS BALL VALVE, REDUCED BORE

One-piece Body, Blowout-proof Stem
with Wing handle
Threaded ends to BS21 (JIS B0203)

4.1MPa WOG non-shock and 1 MPa WOG non-shock at 150°C

⚠ Don't use for Flammable gas or Toxic gas



Fig.BKT

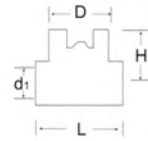

Dimensions

Nominal Size	unit:mm			
	inch	1/4	3/8	1/2
	mm	8	10	15
d1		5	7.5	9
L		40	44.5	54.5
H		30	33	35
D		46	46	46

Materials

Parts	Material (JIS)
Body/cap	C3771BE
Ball	C3604BE Nickel-chrome plated
Stem	C3604BD Nickel plated
Pacing	R-PTFE
Ball seat	R-PTFE

Ball valves

TYPE 400

3-WAY BRASS BALL VALVE

Screwed Body cap, 2-seat, L-port design,
Blowout-proof Stem, Double O-ring stem seals,
Threaded ends to BS21 (JIS B0203)

2.8MPa WOG non-shock and 0.7 MPa WOG non-shock at 150°C

⚠ Don't use for Flammable gas or Toxic gas



Fig.BN

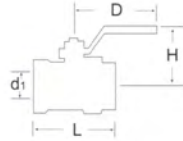

Dimensions

unit:mm

Nominal Size	inch	3/8	1/2
	mm	10	15
d1		9.5	9.5
L		42	51
H		32	32
D		75	75

Materials

Parts	Material (JIS)
Body/cap	C3771BE
Ball	C3604BE Nickel-chrome plated
Stem	C3604BD Nickel plated
O-ring	FKM
Ball seat	PTFE

ALLOWABLE PORT ORIENTAION

Valve Design

3-way, 2-seated L-port ball valve

Form

Fluid Passage

Top View

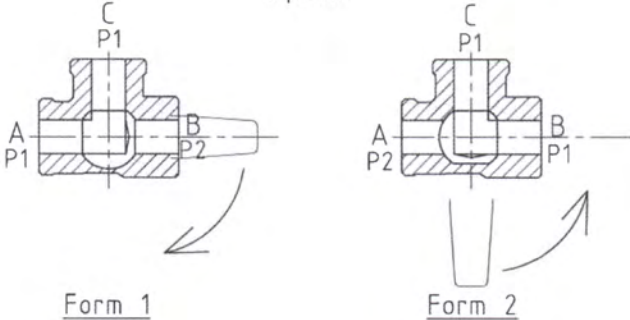

1 Flow is between Ports "A" and "C" in Form 1. Flow is between Ports "B" and "C" in Form 2. Flow paths in Form 1 and Form 2 can be changed each other.

2 When the fluid pressure P2 in the closed path is higher than P1 in the open path, a little fluid leakage may occur to P1 side through the ball seat of the closed path.